

---

# SRDJAN MANOJLOVIC

---

Henderson, NV • [srdan.manojlovic@gmail.com](mailto:srdan.manojlovic@gmail.com)



## Architectural Designer

---

### Summary

---

- Analytical mindset and problem-solving skills necessary to develop rapid solutions, strong work ethic, leadership and interpersonal skills, proactive and committed to team success and design excellence, ability to work on multiple projects simultaneously under strict deadlines- Highly versatile architect with well balanced technical knowledge and broad design experience working in all project phases from Conceptual Design to Construction Administration, on USA, Russia, Saudi Arabia, Armenia, Montenegro and Serbia markets- Relevant design experience in large scale mix-use and residential projects, data centers, commercial, hospitality, recreation, cultural centers, landmark reconstructions and adaptive reuse- Specialty in theaters, multipurpose arenas, auditoriums, sports halls and stadiums- Strong software skills as well as hand rendering and sketching skills - 12+ year professional experience in using knowledge of construction technology and architectural practices, project managing and technical coordination with MEP, structural and civil engineers and specialized consultants

---

### Work experience

---

04/2019 - 07/2020

#### Job Captain

##### *PLIRIS Design Studio, Las Vegas NV*

Designed and assembled construction document sets, delegated work assignments to project team members, provided coordination between engineering disciplines, reviewed drawings for building code and accessibility compliance, communicated with clients, city officials, and vendors.

Worked on a variety of new construction projects: commercial centers, self-storage warehouses, and automotive buildings like quick-lanes and car dealerships for Team Ford. Also worked on tenant improvement projects for business offices, hospitality, dispensaries, convenience stores, and beauty salons.

##### Project Examples:

- U-Haul of Tule Springs at E Deer Springs Way and N 5th St, North Las Vegas - new construction
- Team Ford Automotive Buildings - new construction: Bronco Barn, Quick Lane, and Car Storage on Rancho, and Lincoln Dealership remodel on Drexel Rd for the same client

04/2015 - 06/2017

#### Senior Designer

##### *Forte Specialty Contractors, Las Vegas NV*

Worked for the general contractor on interior remodeling design-build projects for casinos and theme parks. Developed and produced design documents based on Design Concept provided by the client, from schematic design and 3D modeling to construction documents, shop, and fabrication drawings. Also worked on high-end feature wall and animatronics projects.

##### Project examples:

- Guardians of the Galaxy theme pavilion, Disney California Adventure, Anaheim CA – interior remodeling, design-build project, coordinated with Disney Imagineering,
- Tryst/ Intrigue at Wynn Las Vegas - interior remodeling construction project,
- Seven Floral Displays at Wynn Palace Cotai Resort, Macau, China - removable stainless steel structure animatronics sculptures, floral design by Preston Bailey.

10/2014 - 04/2015

#### Senior Designer

##### *Engineered Wall Systems Midwest, Munster IN*

Provided building enclosure engineering services that included developing the metal panel façade layouts, assembly plans, detailing, shop drawings, estimating, cost control, take-offs, 3D modeling, and communication with the architect, suppliers, and sub-contractors.

##### Project examples:

- Ethos Dental Office, Munster, IN – interior remodeling design/build project,
- Park Plaza Senior Living, Chicago, IL - building enclosure engineering.

10/2012 - 10/2014

#### Senior Designer

*The Hill Group - Hill Architectural Systems, Chicago IL*

Designed and developed facade layouts, assembly plans, details, and shop drawings for building enclosures, coordinated the work with architectural companies and general contractors such as Exp. and Turner Construction, as well as with subcontractors and suppliers, in a general contractor or subcontractor role.

Project examples - building enclosure engineering:

- Lycée Français de Chicago
- 1611 West Division, Chicago IL
- Western Illinois University - Riverfront Campus, Moline IL.

09/2011 - 10/2012

Freelance Architectural Consultant

*Uchida Kolacz Design*

Responsible for producing drawings and coordination between technical disciplines.

Interior projects:

- Financial institution, Chicago, IL (13,000 sq ft) - FF&E and work-space planning,
- Legal assistance offices, Chicago (50,000 sq ft) - adaptive reuse design/build project, FF&E,
- Long term care facilities, Chicago (15,000 sq ft) - interior alterations, work-space planning.

04/2010 - 05/2011

Freelance Architectural Consultant

*Sheehan Partners, Ltd*

Data Centers:

Worked on projects for collocation and single user data centers, on new construction as well as adaptive reuse, for top IT clients, in NY, NJ, OR and TX . Responsible for producing drawings in all project phases, with an emphasis on detailing.

10/2007 - 02/2009

Architectural Professional

*Skidmore, Owings & Merrill LLP*

Large scale mix-use

- Al Oula International, Al Khobar, Kingdom of Saudi Arabia (2,600,000 sq ft), mix-use tower including office space, five star hotel and club, alongside a three-story of high-end retail, hotel banqueting and conference facilities - was responsible for developing design schemes, technical coordination and design documents production for 30% of the overall project area.
- Encinal Tower, 1938 Broadway, Oakland, CA - design presentations.

10/2005 - 05/2007

Project Architect

*Romanticna Arhitektura*

Directed multiple projects simultaneously, managed technical coordination with outsource architectural and interior design team, MEP, structural, civil, landscape and other consultants.- Cultural Center "Rakovica", Belgrade - Adaptive reuse, renovation and addition project "Mercedes-Benz" Truck Center, Dobanovci, Belgrade - Planning and Schematic Design

Sports Facilities: - Soccer Stadium Complex "Cukaricki Stankom", Belgrade, including commercial spaces and "Stankom" Hotel - Schematic Design/Construction Documents (645,000 sq ft)- Athletic and Soccer Stadium, Yerevan, Armenia - SD and DD (1,080,000 sq ft)- Sports Center "Rakovica", Belgrade - adaptive reuse, renovation and addition (72,000 sq ft)

Residential/ commercial complexes, Residential Buildings and Houses - SD/CA:- "Sunny Slope", Belgrade (75,000 sq ft)- "Karijatide" , Belgrade (162,000 sq ft)

03/2004 - 07/2005

Project Architect

*Svetlost Teatar*

Managed and coordinated multidisciplinary team on several projects simultaneously, developed customized turn-key solutions and provided consulting in theater/stage technologies.

Adaptive reuses - interior design/build:- Yugoslav Film Archive, Belgrade Serbia - TV Studio, Civic Center "Millennium", Vrsac, Serbia

Multipurpose Arenas, Theaters and Multipurpose Auditoriums - Theater, auditorium and sports consulting and design/build, stage machinery and remotely controlled mobile rigging:- "Belgrade Arena", Serbia (22,000 seats)

- Sports Center "Moraca", Podgorica, Montenegro- "Zvezdara Theater", Belgrade - Music Theater "Terazije", Belgrade

- Barvikha Luxury Village Concert Hall, Moscow, Russia - multipurpose auditorium

- Convention Center, Civic Center "Millennium", Vrsac, Serbia - multipurpose auditorium.

## Education

Graduate Engineer of Architecture

Faculty of Architecture, University of Belgrade

- Professional State License Examination in Serbia (2005)- Graduate Engineer of Architecture, certified equal as MS in Architecture, Faculty of Architecture, University of Belgrade, Serbia (2002) - Architectural Technician, High School of Architecture and Civil Engineering, Belgrade, Serbia (1990)

## Recent Projects

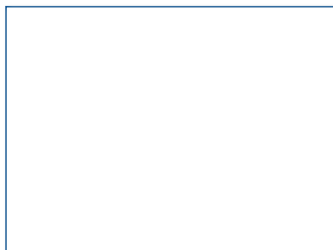

## Portfolio Samples

## Theater and Sports Projects

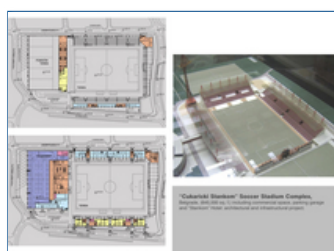
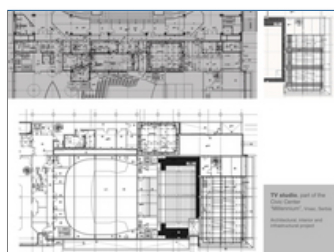
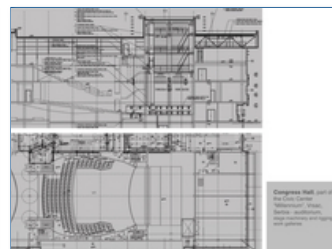
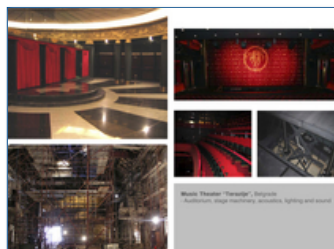
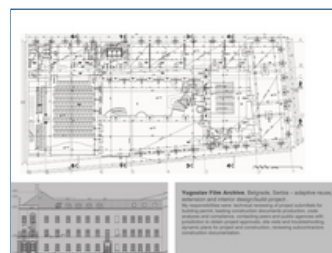
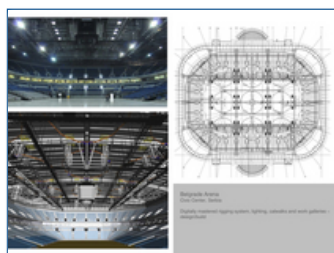

Revit

SketchUp

3D Studio MAX

Adobe PhotoShop and Illustrator

AutoCAD

Newforma

QuarkXPress

Microsoft Project

Microsoft Office

